

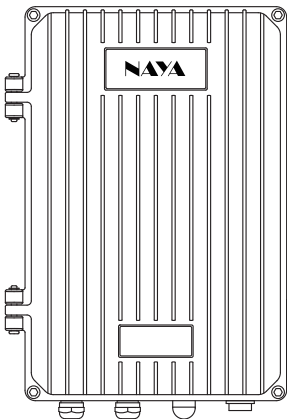

User's manual of
wireless repeater(outdoor)
PNI-RP2710



Please keep the manual for reference

Content

1 Check the items in the package	3
2 Parts introduction	3
2.1 Interface.....	3
3 Installation diagram of repeater	4
3.1 Diagram of wiring installation.....	4
3.2 Installation diagram of back mounting plate.....	5
3.2 Installation diagram of back mounting plate.....	6
3.4 Installation diagram of antenna.....	7
4 Using instructions of single repeater	8
5 Using instructions of multi-repeaters networking	9
6 LAN networking diagram of multi-repeaters	10
7 WAN networking diagram of multi-repeaters	11
8 Warranty policy	12
9 Non-insurance policy	12
10 Warranty card	13

1 Check the items in the package

◆ The package contains the following items, if any damage or loss, please contact Naya or the dealer you purchased from.

No.	Item	Q'ty
1	Outdoor repeater	1
2	Manual	1

2 Parts introduction

2.1 Interface

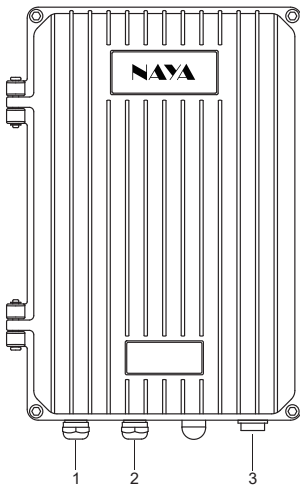

No.	Items	Description
1	Power interface	220V/AC power bayonet
2	Networking interface	Networking cable bayonet
3	Networking interface	Signal antenna bayonet

3 Installation diagram of repeater

3.1 Diagram of wiring installation

- ◆ Unbox: loosen the upper shell screw with the 5# hex wrench to open the shell.

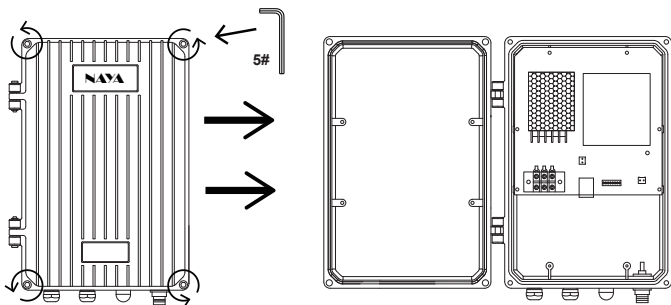

- ◆ Remove the latch: remove the metal latches of the power cable and network cable with 18# wrench.

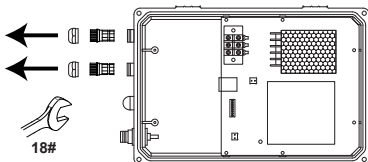

- ◆ Power wiring: attach the metal latch to the power cable and then connect it to the binding post.
- ◆ Attach the metal latch to the networking cable, then press the crystal tip with the mesh cable clamp and insert it on the networking cable holder, or connect the networking cable directly to the binding post without pressing the crystal tip.
- ◆ Locking: After the power cable and network cable should be locked with metal clasp after connection of the two cables.
- ◆ Close the outer case: after the above operation, close the upper lid and tighten the screws.

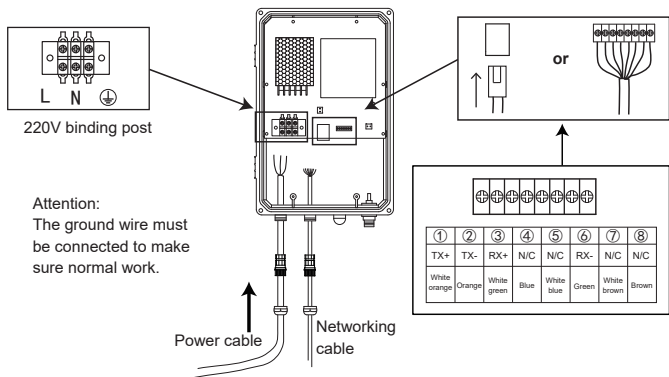

3.2 Installation diagram of back mounting plate

- ◆ Install back mounting plate: lock and fix the M5 hex screws with 5# hex wrench.

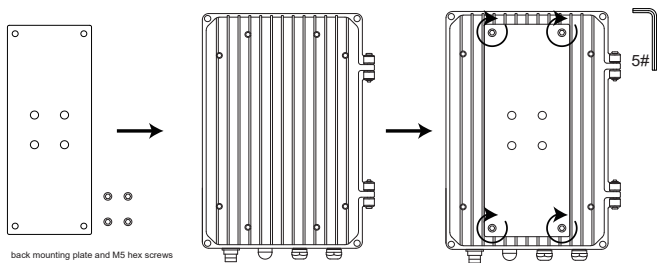

3.3 Installation diagram of L plate

- ◆ Fix L plate to installed back mounting plate, lock and fix M5 nut with 8# wrench.

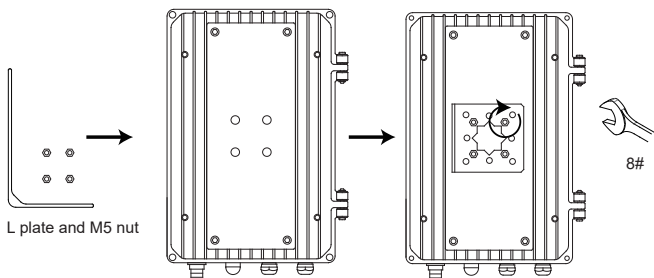

- ◆ Install and fasten the repeater: lock and fix M6 nut with 10# wrench.

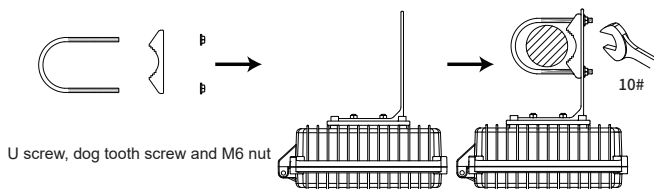

3.4 Installation diagram of antenna

- ◆ Install and fasten antenna, lock M6 nut with 10# wrench.

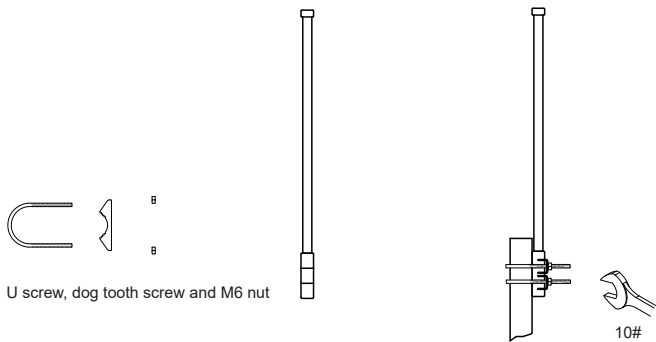

Product parameters

Protection class	IP67	Operating temperature	FSK/GFS
Transmit power	0.25W	Working style	wDR-8
Operating temperature	-20°C - 60°C	Operating voltage	100-220 VAC



Please read the manual carefully before using

Website: <http://www.nayatec.com>

Manufacturer: Shanghai Naya Intelligence Technology. Co.,Ltd.

Address: No.7001 Zhongchun RD., Shanghai, 201101, China

4 Using instructions of single repeater

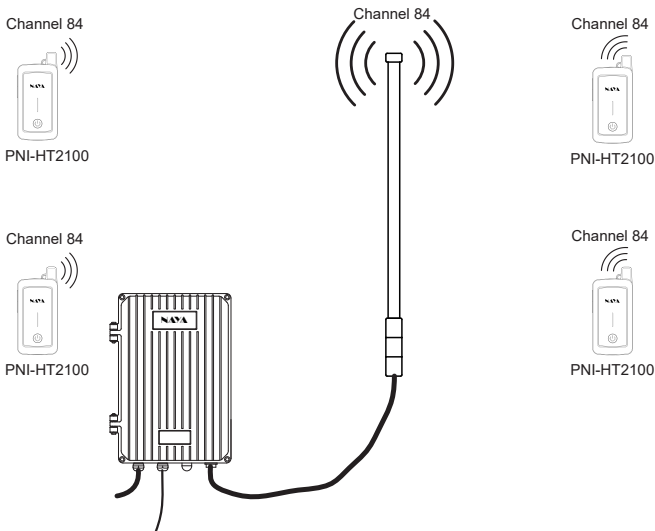

Note: The channel layout in this manual is for the installation solution reference only.

- ◆ Initial state: The default channel of the repeater in the single relay mode is 84, corresponding to the channel 84 of the handheld terminal, after the repeater is powered on, the handheld terminal switches to the channel 84 for call, without any settings.
- ◆ Full-duplex ways: unlimited handheld terminals added in the single relay mode, but just 4 users can speak simultaneously, others can just hear.
- ◆ Channel adjustment: If you need to use other channels in a single relay mode, please contact the reseller for configuration.

5 Using instructions of multi-repeaters

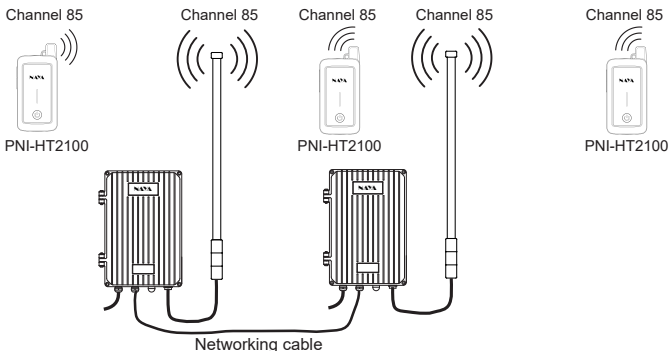

Note: The channel layout in this manual is for the installation solution reference only.

◆ In the multi-relay mode, please ask the dealers to pre-configure channels and networking parameters of multiple repeaters, and then the configured multiple repeaters can be connected through the network cable when powered on. At this time, the handheld terminal channel should be adjusted to the correct channel according to the requirements of the dealer.

◆ After the above configuration is completed, the handheld terminal can be powered on to conduct the conversation. All handheld terminals under different repeaters are interconnected.

◆ When a handheld terminal enables the roaming function: if the terminal moves from coverage of one repeater to the coverage of another repeater, its channel will automatically switch to the same channel of the repeater with a stronger signal for call, without manual switching.

◆ The handheld terminal roaming channel is a multi-relay channel, and the specific channel is configured according to the requirements of the dealer. To modify the repeater channel, please contact your dealer.

6 LAN networking diagram of multi-repeaters

◆ LAN proper connection diagram

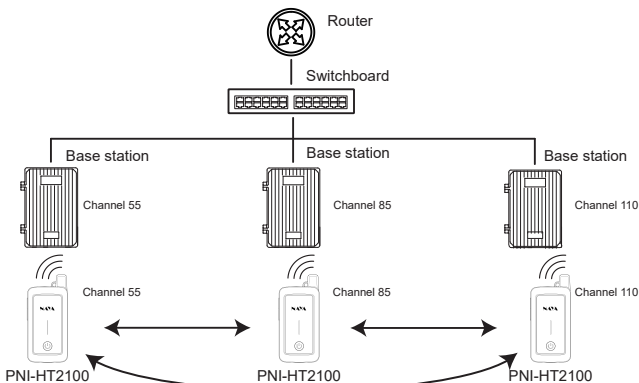

◆ LAN fault connection diagram

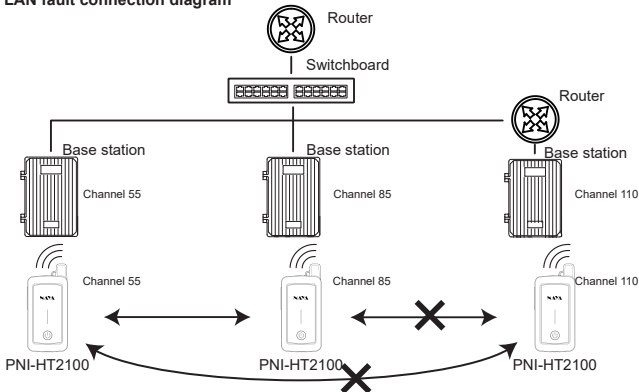

7 WAN networking diagram of multi-repeaters

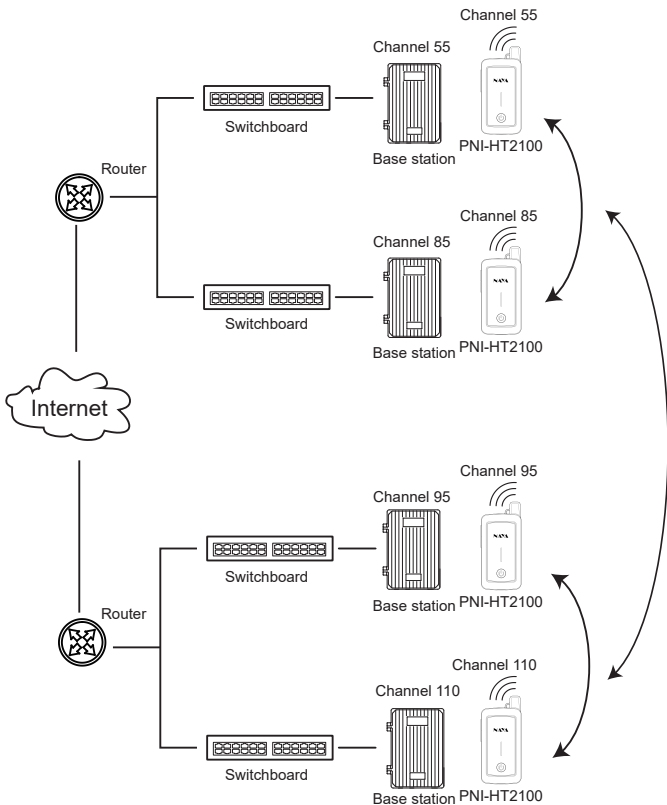

Note: The channel layout in this manual is for the installation solution reference only.

- ◆ The port mapping function of the router is required for Wan connections. Mapping port number: 23457(please contact the professional network engineer for setting).
- ◆ The public IP address must be a fixed IP, and the dynamic IP address cannot be used normally.
- ◆ The base station needs to set the server IP address, please contact the dealer for modification.

8 Warranty policy

Naya promises that defects in material or workmanship under normal operating and maintenance conditions of all devices produced by our company, are covered by the warranty service specified below from the date of purchase.

- ◆ Scope and duration of warranty: 12 months
- ◆ Warranty application
- ◆ If you apply for product maintenance, please be sure to provide the warranty card or valid purchase invoice as a certificate. During the period, the relevant signs of the products shall be kept clean and complete and shall not be torn up.

9 Non-insurance policy

If the following conditions occur, it is not covered by the warranty, maintenance and repair should be paid:

- ◆ Failure or damage caused by unauthorized dismantling, repair, modification, misuse, abuse, liquid infeed, accident, use of non-original accessories.
- ◆ Out of warranty.
- ◆ Damage caused by force majeure.
- ◆ Any damage caused by failure to comply with the requirements of the manual and maintenance.
- ◆ The performance failure of products and accessories is caused due to human reasons.
- ◆ Malicious damage to warranty card content or fuselage information, including blurred damage, self-tearing and tampering, etc.
- ◆ Other failures and damage caused by problems such as design, manufacture, and quality of the device.

- ◆ Products sold to Chinese mainland only be under national joint warranty service in Chinese mainland.

10 Warranty card

- ◆ In order to protect your rights and interests, please fill in it carefully and keep it properly as a certificate for maintenance.

Reseller information			
Model		Sales date	
Reseller		Contact telephone/E-mail	
User information			
User name		Contact telephone	
Address		E-mail	